

NanQue®



DZ47Z-63X

DC250~1000V

Photovoltaic DC circuit breaker

Series

Seiko manufacturing, quality can be seen



Product Introduction

DZ47Z-63X DC miniature circuit breaker series is mainly used in DC lines with rated voltage up to 1000V and rated working current up to 63A, for overload and short circuit protection of DC lines and infrequent conversion of lines. The circuit breaker is composed of a plastic casing, an operating mechanism, a contact arc extinguishing system, and a tripping mechanism. The shell is made of high flame-retardant, high-strength special plastic, which has strong impact resistance and light weight.

This product complies with GB10963.2 and IEC60947-2 standards.



Model Meaning

DZ47Z-63X-1P-C10A-T

Model

B: B-curve
C: C-curve
D: D-curve

Blank: white shell
T: transparent shell

Poles

Rated current



Technical Parameters



- Short circuit protection
- Overload protection (overcurrent protection)
- Isolation function
- Auxiliary control function
- Rated current I_n : 1A, 2A, 3A, 4A, 5A, 6A, 10A, 16A, 20A, 25A, 32A, 40A, 50A, 63A;
- Rated working voltage U:
DC250V/DC500V/DC750V/DC1000V;
- Rated short-circuit breaking capacity I_{cn} : 6kA
- Rated impulse withstand voltage U_{imp} (1.2/50): 6kV
- Number of poles: 1P single pole, 2P double pole, 3P triple pole, 4P quadrupole;
- Trip form: thermal magnetic trip;
- Tripping characteristics: C type ($5I_n \sim 10I_n$), D type ($10I_n \sim 20I_n$);
- Current limiting level: 3
- Ambient working temperature: $-30^\circ\text{C} \sim 70^\circ\text{C}$



IP grade: IP20;

Pollution level: 2;

Installation method: Installation: where there is no significant vibration and shock, tunnel wiring

Terminal, can be easily installed on TH35-7.5 type DIN standard rail

Installation torque: 1~32A and below: 2.5N, 40-63A: 3.5N.

Mechanical and electrical life:

a. Electrical life: not less than 8000 times;

b. Mechanical life: not less than 10,000 times.

Compliant with the standard: GB10963.2/IEC60947-2

Compliance certification: CCC, CE

Application place:

It is used in DC power power system, electric propulsion system, photovoltaic power system (photovoltaic combiner box) and other places.

Tripping Characteristic Curve

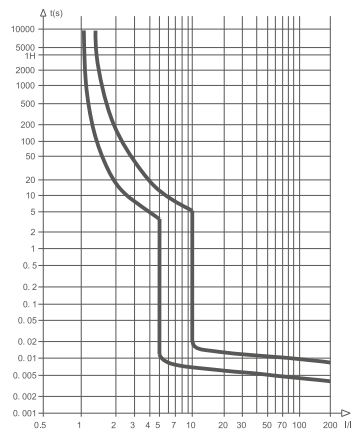

C-curve

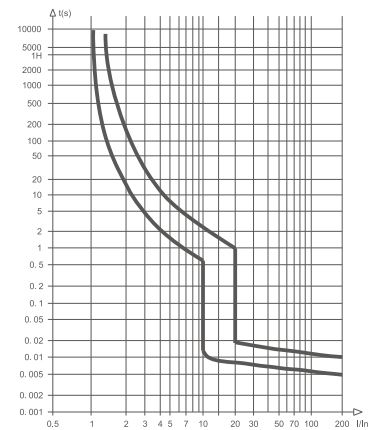



D-curve

Temperature Current Correction Factor

Temperature°C	-30	-20	-10	0	10	20	30	40	50	60	70
Current factor	1.3	1.25	1.2	1.15	1.1	1.05	1	0.95	0.9	0.85	0.8

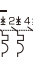

Product Selection

Model	Poles	Current	Shell
DZ47Z-63X	1P 	1A, 2A, 3A, 4A, 5A, 6A, 10A, 16A, 20A, 25A, 32A, 40A, 50A, 63A	white (default) Transparent (customized) Other colors (mass customization)
	2P 		
	3P 		
	4P 		

Product Size

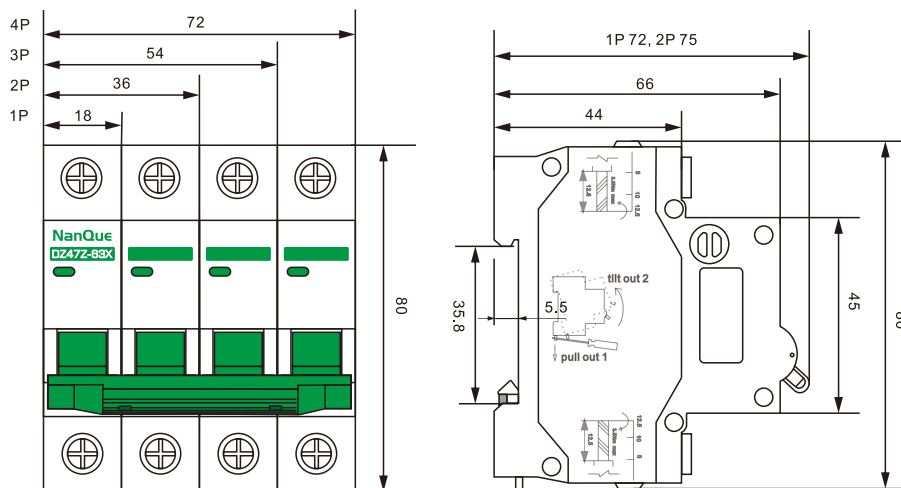

Connecting Cables

Current	Recommended cable cross-section	Maximum wiring capacity
1~6A	1mm ²	25mm ²
10A	1.5mm ²	
16~20A	2.5mm ²	
25A	4mm ²	
32A	6mm ²	
40~50A	10mm ²	
63A	16mm ²	



Ordering Instructions

1. When ordering, the user should indicate the product model, tripping type, rated current, Rated Voltage, number of poles, accessories and quantity of the circuit breaker.
2. Example: DZ47Z-63X circuit breaker 2P C63A DC500V, 200 pieces.
3. Users have special requirements, such as custom printing, which can be negotiated separately.

Appendix I

Product selection datasheet



1P



2P



3P



4P

Product Model	Poles	Voltage	Current	Order Code	Customized
DZ47Z-63X	1P	DC250V	1A	NQPD-DZ47ZX1PD1001	Yes
	1P	DC250V	2A	NQPD-DZ47ZX1PD1002	Yes
	1P	DC250V	3A	NQPD-DZ47ZX1PD1003	Yes
	1P	DC250V	4A	NQPD-DZ47ZX1PD1004	Yes
	1P	DC250V	5A	NQPD-DZ47ZX1PD1005	Yes
	1P	DC250V	6A	NQPD-DZ47ZX1PD1006	No
	1P	DC250V	10A	NQPD-DZ47ZX1PD1007	No
	1P	DC250V	16A	NQPD-DZ47ZX1PD1008	No
	1P	DC250V	20A	NQPD-DZ47ZX1PD1009	No
	1P	DC250V	25A	NQPD-DZ47ZX1PD1010	No
	1P	DC250V	32A	NQPD-DZ47ZX1PD1011	No
	1P	DC250V	40A	NQPD-DZ47ZX1PD1012	No
	1P	DC250V	50A	NQPD-DZ47ZX1PD1013	No
	1P	DC250V	63A	NQPD-DZ47ZX1PD1014	No
	2P	DC500V	1A	NQPD-DZ47ZX2PD2001	Yes
	2P	DC500V	2A	NQPD-DZ47ZX2PD2002	Yes
	2P	DC500V	3A	NQPD-DZ47ZX2PD2003	Yes
	2P	DC500V	4A	NQPD-DZ47ZX2PD2004	Yes
	2P	DC500V	5A	NQPD-DZ47ZX2PD2005	Yes
	2P	DC500V	6A	NQPD-DZ47ZX2PD2006	No
	2P	DC500V	10A	NQPD-DZ47ZX2PD2007	No

Product Model	Poles	Voltage	Current	Order Code	Customized
DZ47Z-63X	2P	DC500V	16A	NQPD-DZ47ZX2PD2008	No
	2P	DC500V	20A	NQPD-DZ47ZX2PD2009	No
	2P	DC500V	25A	NQPD-DZ47ZX2PD2010	No
	2P	DC500V	32A	NQPD-DZ47ZX2PD2011	No
	2P	DC500V	40A	NQPD-DZ47ZX2PD2012	No
	2P	DC500V	50A	NQPD-DZ47ZX2PD2013	No
	2P	DC500V	63A	NQPD-DZ47ZX2PD2014	No
	3P	DC750V	1A	NQPD-DZ47ZX3PD3001	Yes
	3P	DC750V	2A	NQPD-DZ47ZX3PD3002	Yes
	3P	DC750V	3A	NQPD-DZ47ZX3PD3003	Yes
	3P	DC750V	4A	NQPD-DZ47ZX3PD3004	Yes
	3P	DC750V	5A	NQPD-DZ47ZX3PD3005	Yes
	3P	DC750V	6A	NQPD-DZ47ZX3PD3006	No
	3P	DC750V	10A	NQPD-DZ47ZX3PD3007	No
	3P	DC750V	16A	NQPD-DZ47ZX3PD3008	No
	3P	DC750V	20A	NQPD-DZ47ZX3PD3009	No
	3P	DC750V	25A	NQPD-DZ47ZX3PD3010	No
	3P	DC750V	32A	NQPD-DZ47ZX3PD3011	No
	3P	DC750V	40A	NQPD-DZ47ZX3PD3012	No
	3P	DC750V	50A	NQPD-DZ47ZX3PD3013	No
	3P	DC750V	63A	NQPD-DZ47ZX3PD3014	No
	4P	DC1000V	1A	NQPD-DZ47ZX4PD4001	Yes
	4P	DC1000V	2A	NQPD-DZ47ZX4PD4002	Yes
	4P	DC1000V	3A	NQPD-DZ47ZX4PD4003	Yes
	4P	DC1000V	4A	NQPD-DZ47ZX4PD4004	Yes
	4P	DC1000V	5A	NQPD-DZ47ZX4PD4005	Yes
	4P	DC1000V	6A	NQPD-DZ47ZX4PD4006	No
	4P	DC1000V	10A	NQPD-DZ47ZX4PD4007	No
	4P	DC1000V	16A	NQPD-DZ47ZX4PD4008	No
	4P	DC1000V	20A	NQPD-DZ47ZX4PD4009	No
	4P	DC1000V	25A	NQPD-DZ47ZX4PD4010	No
	4P	DC1000V	32A	NQPD-DZ47ZX4PD4011	No
	4P	DC1000V	40A	NQPD-DZ47ZX4PD4012	No
	4P	DC1000V	50A	NQPD-DZ47ZX4PD4013	No
	4P	DC1000V	63A	NQPD-DZ47ZX4PD4014	No
	2P	DC1000V	1A	NQPD-DZ47ZX2PD4001	Yes
	2P	DC1000V	2A	NQPD-DZ47ZX2PD4002	Yes
	2P	DC1000V	3A	NQPD-DZ47ZX2PD4003	Yes
	2P	DC1000V	4A	NQPD-DZ47ZX2PD4004	Yes

Product Model	Poes	Voltage	Current	Order Code	Customized
	2P	DC1000V	5A	NQPD-DZ47ZX2PD4005	Yes
	2P	DC1000V	6A	NQPD-DZ47ZX2PD4006	No
	2P	DC1000V	10A	NQPD-DZ47ZX2PD4007	No
	2P	DC1000V	16A	NQPD-DZ47ZX2PD4008	No
	2P	DC1000V	20A	NQPD-DZ47ZX2PD4009	No
	2P	DC1000V	25A	NQPD-DZ47ZX2PD4010	No
	2P	DC1000V	32A	NQPD-DZ47ZX2PD4011	No
	2P	DC1000V	40A	NQPD-DZ47ZX2PD4012	No
	2P	DC1000V	50A	NQPD-DZ47ZX2PD4013	No
	2P	DC1000V	63A	NQPD-DZ47ZX2PD4014	No

illustrate:

- 1, "Customized products" (gray marked), cannot be ordered directly, you need to determine the quantity, price and order cycle before ordering,
- 2, Customized products does not support returns and exchanges.