



PRODUCT INTRODUCTION

NQQ7-800 series automatic transfer switching equipment is suitable for three-phase four-wire dual-circuit power supply grids with an alternating current of 50Hz/60Hz, a rated working voltage of AC110V/AC230V/AC400V, and a rated working current of up to 800A. It can automatically transfer one or several load circuits from one power source to another to ensure the normal power supply of the load circuits. This product is applicable to relatively important places such as industrial, commercial, high-rise buildings and civil residences.

The ATS compliant with GB/T 14048.11 and IEC 60947-6-1 standard

PARAMETERS

Product Model	NQQ7-100		NQQ7-225	NQQ7-315	NQQ7-800
Type	Grid (P) - Grid (P), Grid (P) - Oil Engine (G), Grid (P)-Photovoltaic(PV)				
Electrical Characteristics					
Pole Number	2P, 3P, 4P				3P, 4P
Rated Current Ie (A)	16, 20, 25, 32, 40, 50, 63, 80, 100	100, 125, 160, 200, 225		200, 225, 250, 315	250, 315, 350, 400, 450, 500, 630, 700, 800
Rated Voltage Ue (V)	110(customized), 230, 400, 415				
Rated Insulation Voltage Ui (V)	800			1000	
Rated Withstand Impulse Voltage Uimp (kV)	8			12	
Rated Impulse Withstand Current Icw (kA)	5/30ms	10/30ms			25/1s
Rated Short - circuit Making Capacity Icm (kA)	8	17			52.5
Electrical category	PC Class				
Usage Category	AC-33B				
Operation Method	Auto, Manual				
Contact Conversion Time (s)	0.6±20%				
Conversion Action Time (s)	1.3±10%				
Recovery Time (s)	1.3±10%				
Power - off Time (s)	0.6±20%				
Electromagnetic Compatibility Environment	Environment B				
Mechanical Characteristics					
Mechanical Service Life (Times)	8000				4000
Electrical Service Life (Times)	2000				1000
Installation Characteristics					
Terminal	Press Plate Type				
Maximum Torque (N.m)	3	5	10	22	
Installation	Vertical Fixed Installation				

SIZE (UNIT: MM)

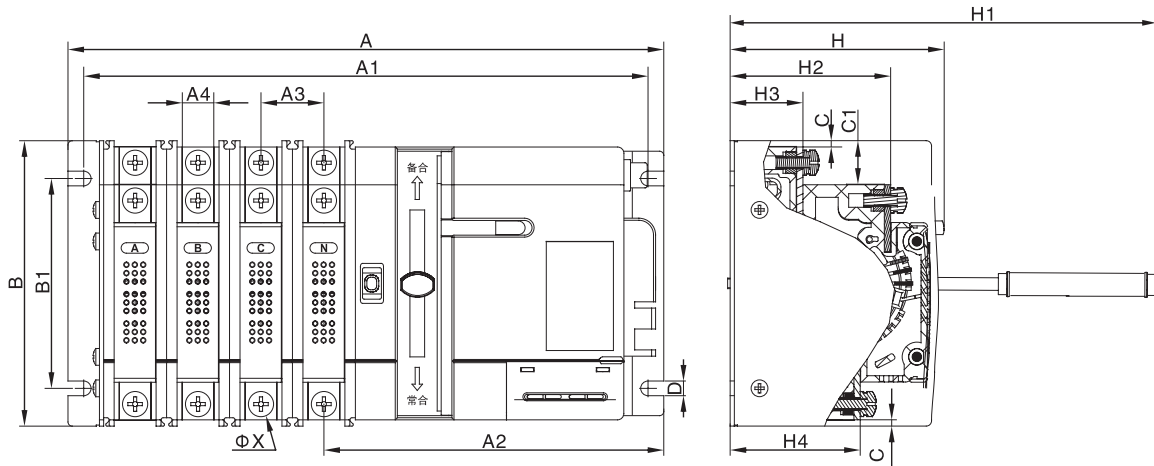

Spec/Size	A			B	H	A1			Bl	A2	A3	A4	Hl	H2	H3	H4	C	Cl	D	X
	2P	3P	4P			2P	3P	4P												
100	171	193	215	138	68	44	66	88	106	136	22	13	152	52	24	43	2	13	5.2	6
225	229	259	289	136	102	214	244	274	100	162	30	15	240	77	35	62	4	21	7	6
315	302	347	393	170	128	283	328	374	125	207	45.5	25	257	96	44	79	4	22	9	8
800	/	528	596	255	192	/	501	569	188	325	68	49	367	144	65	118	6	40	13	120

WIRING METHOD

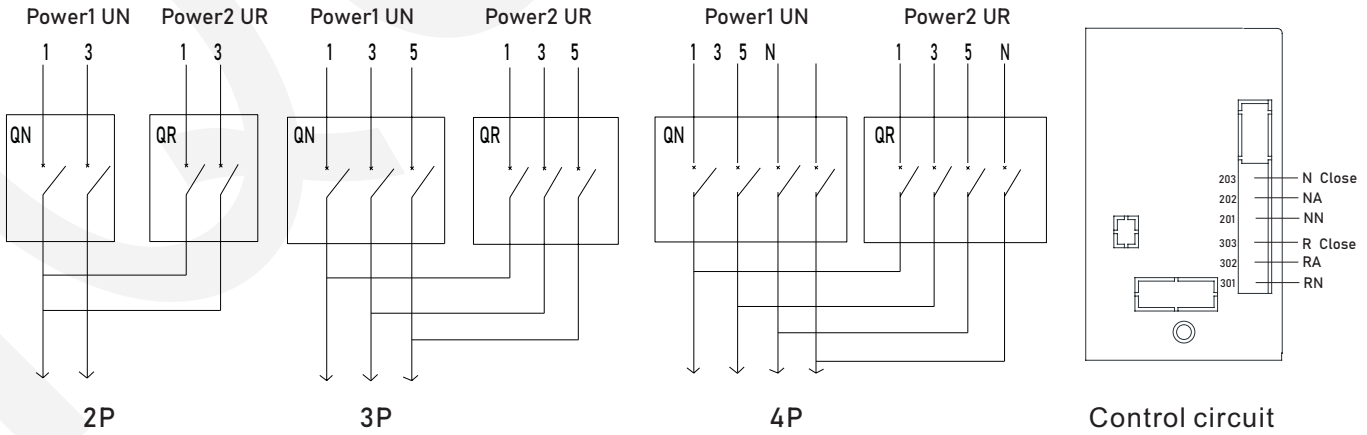

PRECAUTIONS AND WARNING

- Pre-operation Safety**  
Disconnect and verify both power sources are dead with a tester before operation. Never work on live units—risk of electric shock. Keep the area free of flammables or dust.
- Mode Switching**  
Check voltage/frequency match before switching manual/auto modes. Avoid forced switching during load surges; may cause malfunctions or damage. Watch for jams/noises manually.
- Maintenance Rules**  
Never skip insulation tests or interlock checks. Clean contacts with alcohol (no sandpaper). Ensure no simultaneous closing of two sources to prevent short circuits.
- Load Limits**  
Never exceed rated current. Avoid sudden heavy inductive loads. Overload can weld contacts or trip circuits. Size ATS for load type, with 1.5-2x margin for inductive loads.
- Abnormal Handling**  
Shut off both sources immediately if ATS switches frequently, smells odd, or flashes. No resetting—risk of fire. Only qualified technicians repair; test after fixing.